

# CONCRETE CURB EDGE DETAIL

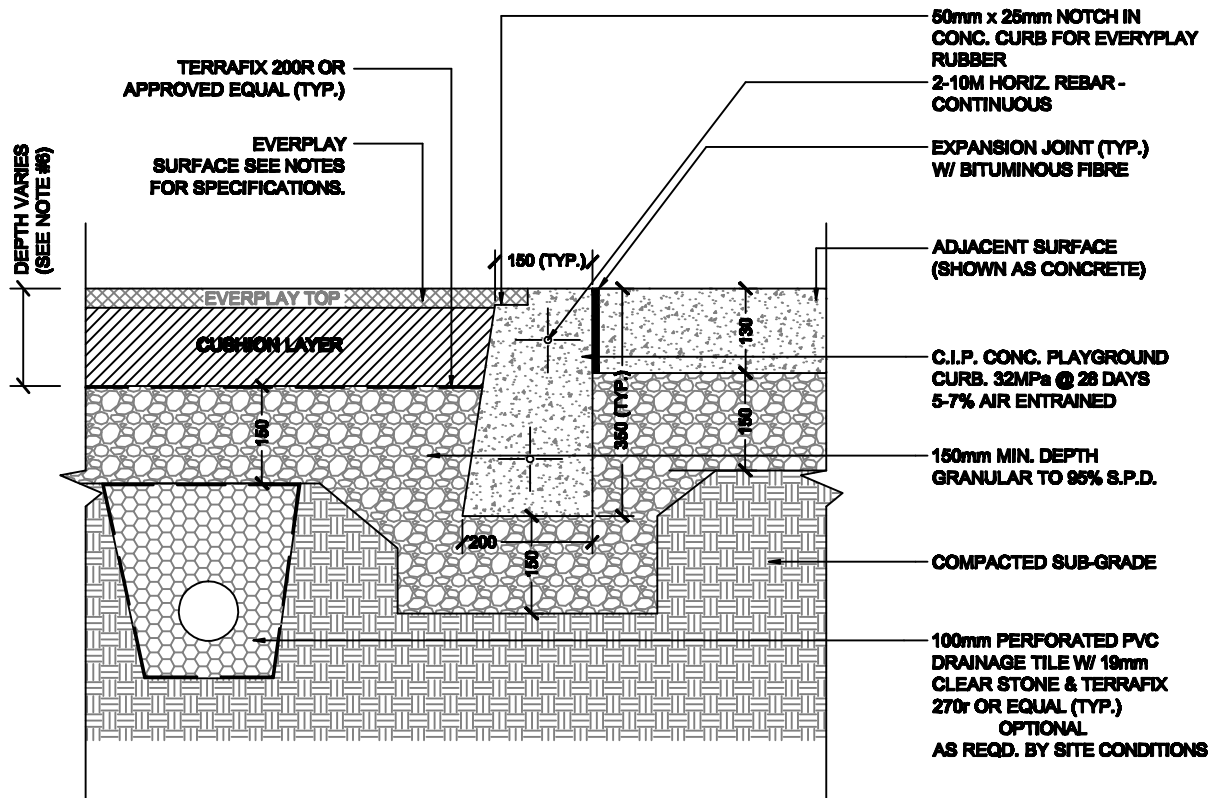

## NOTES:

1. ALL PLAYGROUND SURFACES TO BE INSTALLED AS PER EVERPLAY SPECIFICATIONS.
2. RUBBERIZED SURFACE TO BE 'EVERPLAY' "IN-SITU".
3. GRANULAR BASE THICKNESS TO MEET ALL APPLICABLE CODES AND GUIDELINES.
4. WARRANTY TO BE 5 YEARS (MATERIALS, WORKMANSHIP & COMPLIANCE TO ASTM-F1292).
5. COLOUR TO BE TERRA COTTA OR GREEN PIGMENTED.
6. PLAYGROUND SURFACE DEPTH TO VARY ACCORDING TO MAXIMUM DROP HEIGHT FROM TOPS OF BARRIERS, SWINGS & CLIMBERS.  $G_{max} < 150$  and  $HIC < 800$ .
7. PLAYGROUND SURFACE TO BE INSTALLED FLUSH TO ADJACENT CURB.

## EVERPLAY Installation Inc.

18 Automatic Road, Unit 12

Brampton, Ontario, Canada L6S 5N5

Tel: 416-410-3056

Fax: 905-494-1136

Tel: 888-EVERPLAY

Email: [rolf@everplay.com](mailto:rolf@everplay.com)

[henry@everplay.com](mailto:henry@everplay.com)

Web: [www.everplay.com](http://www.everplay.com)

Drawn By: M. de Richmond  
Date: 30/01/2010